

75m - 3.600kg

70m - 4.300kg

65m - 5.100kg

60m - 6.000kg

55m - 6.500kg

50m - 7.000kg

48m - 7.600kg

43m - 8.600kg

38m - 9.600kg

I

II

III

IV

V

VI

VII

VIII

IX

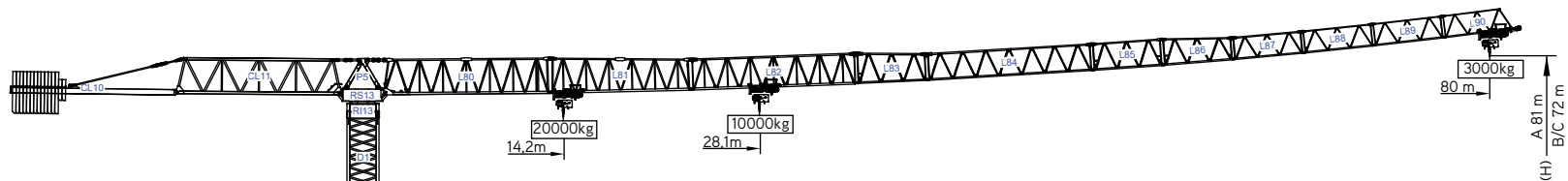

Cargas.Loads.Lasten.Charges.Cargas.Carichi.Yükler.ГРУЗОПОДЪЕМНОСТЬ

Icon	Jib Diagram	Lift Capacity (kg)	Lift Height (m)	Tower Height (m)	Jib Length (m)															
					10	15	20	25	28	33	38	43	48	50	55	60	65	70	75	80
28000 kg 13x2000 + 2x1000 kg	80m	28000 kg	28,1 m	81 m	10000	10000	10000	10000	10000	8440	7220	6290	5550	5300	4740	4280	3890	3550	3260	3000
			14,2 m	72 m	20000	18920	13840	10790	9490	7840	6620	5690	4950	4700	4140	3680	3290	2950	2660	2400
28000 kg 13x2000 + 2x1000 kg	75m	28000 kg	30,5 m	72 m	10000	10000	10000	10000	10000	9230	7910	6900	6100	5820	5220	4720	4290	3930	3600	
			15,4 m	63 m	20000	20000	15150	11840	10420	8630	7310	6300	5500	5220	4620	4120	3690	3330	3000	
28000 kg 13x2000 + 2x1000 kg	70m	28000 kg	33 m	63 m	10000	10000	10000	10000	10000	10000	8620	7530	6660	6360	5710	5170	4710	4300		
			16,7 m	54 m	20000	20000	16510	12920	11390	9450	8020	6930	6060	5760	5110	4570	4110	3700		
27000 kg 13x2000 + 1x1000 kg	65m	27000 kg	35,5 m	54 m	10000	10000	10000	10000	10000	10000	9330	8150	7220	6900	6200	5610	5100			
			17,9 m	45 m	20000	20000	17840	13990	12340	10260	8730	7550	6620	6300	5600	5010	4500			
26000 kg 13x2000 kg	60m	26000 kg	37,7 m	45 m	10000	10000	10000	10000	10000	10000	9980	8720	7730	7390	6650	6000				
			19,1 m	36 m	20000	20000	19070	14980	13220	11010	9380	8120	7130	6790	6050	5400				
24000 kg 11x2000+2x1000 kg	55m	24000 kg	37,2 m	36 m	10000	10000	10000	10000	10000	10000	9810	8570	7600	7260	6500					
			18,8 m	27 m	20000	20000	18760	14720	13000	10820	9910	7970	7000	6660	5900					
22000 kg 10x2000+2x1000 kg	50m	22000 kg	36,2 m	27 m	10000	10000	10000	10000	10000	10000	9510	8310	7360	7000						
			18,2 m	18 m	20000	20000	18190	14270	12590	10470	8910	7710	6760	6400						
21000 kg 10x2000+1x1000 kg	48m	21000 kg	37,3 m	18 m	10000	10000	10000	10000	10000	10000	9790	8560	7600							
			18,8 m	9 m	20000	20000	18720	14700	12970	10790	9190	7960	7000							
19000 kg 9x2000+1x1000 kg	43m	19000 kg	37,4 m	9 m	10000	10000	10000	10000	10000	10000	9840	8600								
			18,9 m	0 m	20000	20000	18820	14770	13040	10850	9240	8000								
18000 kg 9x2000 kg	38m	18000 kg	36,6 m	0 m	10000	10000	10000	10000	10000	10000	9600									
			18,5 m	-9 m	20000	20000	18420	14450	12760	10610	9000									

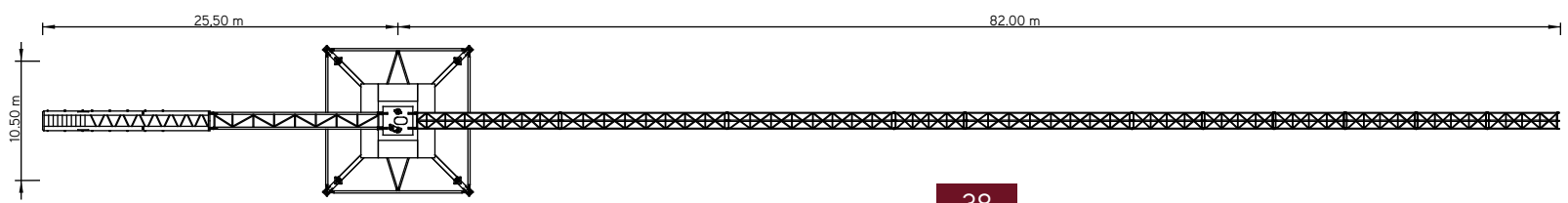
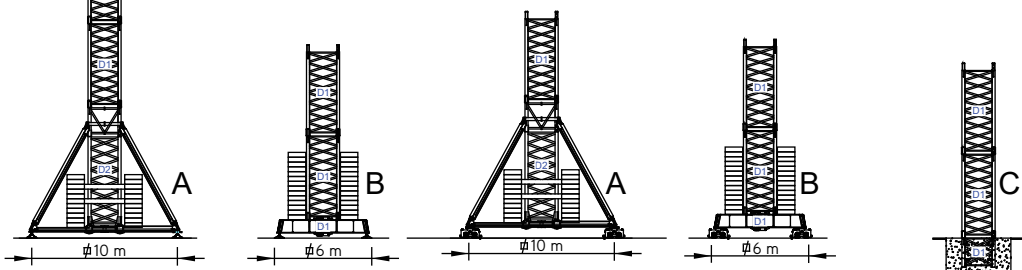





SGT8030TL

# SGT 8030TL

80m - 3.000kg 20.000Kg

Características . Characteristics . Eigenschaften  
Caractéristiques . Caratteristiche . Caratteristiche  
Özellikler . ХАРАКТЕРИСТИКИ

	
	0 a 1 r.p.m. 4x8 daN.m
	0 a 60 m/min 11 kW
	0-10 m/min 4x5,5 kW

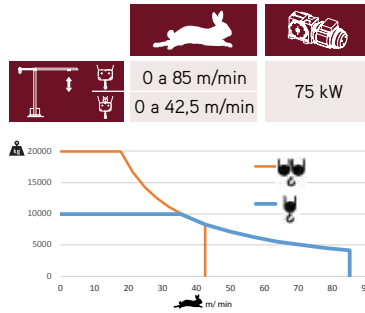
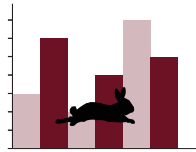





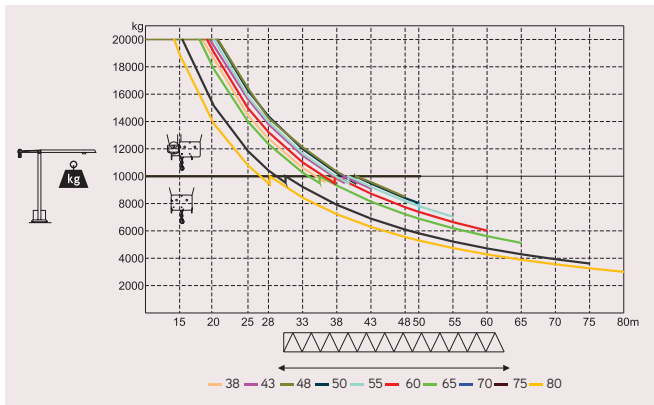
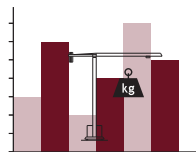





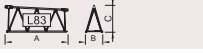
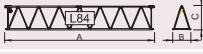
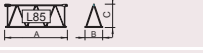

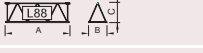

	140 kVA 400 V +- 5% (50/60 Hz)
---	-----------------------------------

Velocidade de elevação . Hoisting speed . Hubgeschwindigkeit . Vitesse d'élevation .  
Velocidad de elevación . Velocità di sollevamento . Kaldırma hızı (m/min) .  
Скорость подъема (м/мин)

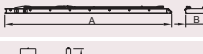
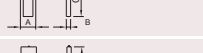
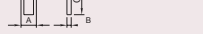

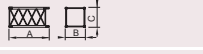
Elementos . Parts . Teile . Éléments . Elementos . Elemento . Parçalar . ЭЛЕМЕНТЫ

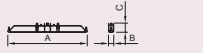
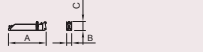
		A (mm)	B (mm)	C (mm)	kg	Code
L80		11825	1540	2410	10100	
L81		10185	1460	2560	3700	
L82		12000	1460	2275	3700	
L83		5275	1460	2230	1300	
L84		11970	1460	1950	2200	
L85		5210	1460	1945	800	
L86		5190	1460	1920	650	
L87		5190	1460	1610	520	533 80 30
L88		5150	1460	1595	400	
L89		5140	1460	1590	350	
L90		5070	1460	1590	400	
RS13 RH13		3430	2200	2310	13000	
P5		3400	1450	1160	2000	
CL11		11935	1450	2425	6200	
CL10		11925	1430	675	2800	
CP4		1600	250	1570	2x1000 2000	704 10 00
CP5		1600	250	2950	13x2000 26000	704 20 00
TOTAL					76120	
D1		6245	2322	2322	4265	533 06 00
D1		3365	2322	2322	2580	533 06 01
D1		2300	2846	2584	2665	533 06 03
D1		2500	2322	2322	2000	533 06 02
D1		8725	800	1600	5500	
D1		4200	380	1600	2x2775 5550	633 00 01
TOTAL					11050	

SGT  
8030TL